

CABIN AIR FILTER

IDENTIFICATION / INSTALLATION

IMPORTS

AF1237 / AFC1237

**Infiniti I30, I35;
Nissan Maxima**



OE: B7200-3Y000

Fits: 2000-01 Infiniti I30
2002-04 Infiniti I35
2000-03 Nissan Maxima

Size: 10 27/32 x 3 7/8 x 1 3/16
(275.4 x 98.4 x 30.2)

Note: Contains Charcoal Impregnated Media for Odor Control
2 Required per Vehicle (Sold as Set of 2)

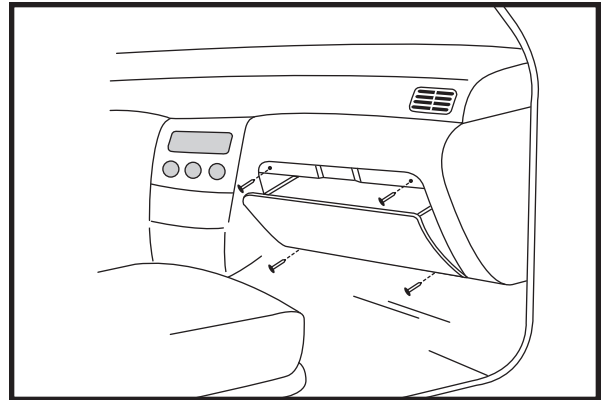

6. Remove screws on glove compartment. (Disconnect the glove compartment light and air bag connectors.)
7. Remove glove compartment.

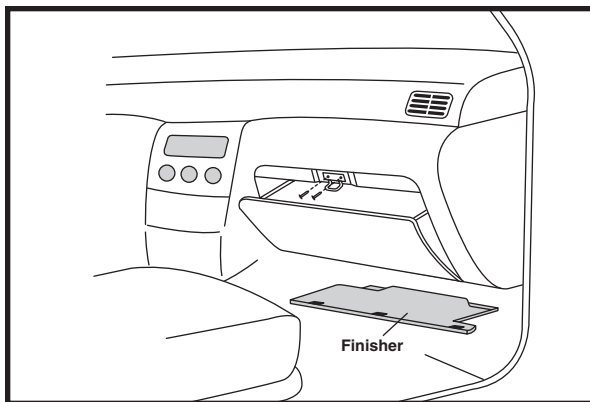

1. Open passenger side door.
2. Unclip and remove finisher (if equipped) located under glove compartment.
3. Open glove compartment.
4. Remove screws on glove compartment latch.
5. Remove glove compartment latch.

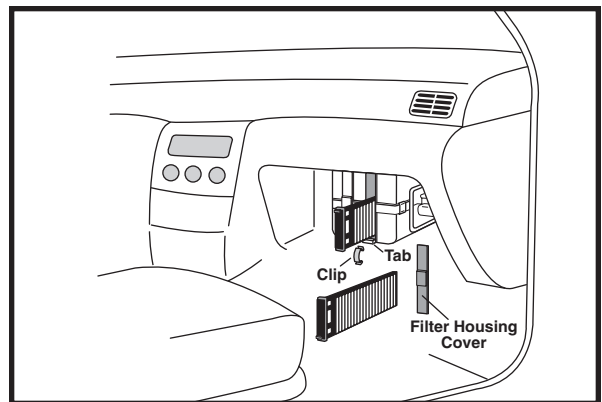

8. Remove filter housing cover.
9. Remove clip on tab.
10. Remove first filter.
11. Slide second filter down and then out. (Factory installed filter may be a single piece filter.)
12. Replace filters in reverse order and reassemble.

Notice: The information provided is based on the latest authoritative information available at press time. However, due to manufacturers' changes, and year and model variations, Hastings Premium Filters cannot be responsible for misapplications and instruction errors.



4400 East Highway 30 ■ P.O. Box 6006
Kearney, NE 68848-6006
PH: 800-887-8836 ■ FAX: 800-210-6906
Internet: www.hastingsfilter.com